

VASCHE Freestanding in Acrilico

Vasche free-standing in acrilico con troppo pieno. Telaio con piedini regolabili, completa di Piletta click clack, Sifone e Tubo Scarico.

Free-standing acrylic bathtubs with overflow. Frame with adjustable feet, complete with click-clack waste, siphon and waste pipe.

BT_01



BT_02



BT_03



DISEGNO TECNICO TECHNICAL DESIGN

BT_01

1700x780x600mm

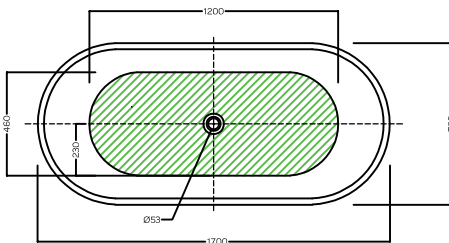

■ Zona posizionamento scarico - Drain positioning area

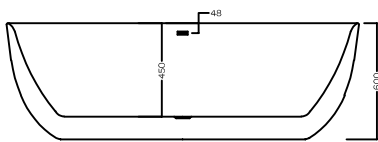

NW. (KG) 45 GW. (KG) 53 WW. (L) 320

BT_02

1700x740x590mm

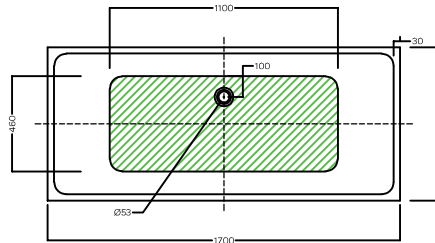

■ Zona posizionamento scarico - Drain positioning area

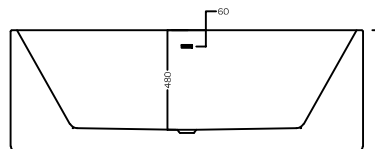

NW. (KG) 50 GW. (KG) 58 WW. (L) 310

BT_03

1700x780x600mm

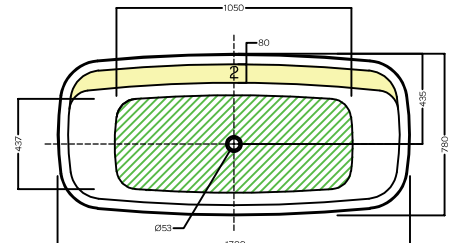

■ Zona posizionamento scarico - Drain positioning area
■ Zona per installazione rubinetteria - Mixer installation area

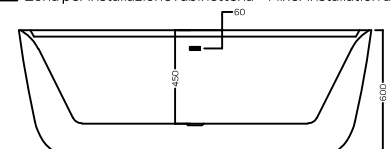

NW. (KG) 42 GW. (KG) 47 WW. (L) 210

ACCESSORI

ACCESSORIES



Piletta click clack, Tubo e sifone di scarico CROMATO

Brass bath tub drainage 50 mm with overflow pipe click-clack CHROME



Piletta click clack Tubo, e sifone di scarico BIANCO MATT Brass bath tub drainage 50 mm with overflow pipe click-clack WHITE MATT

GAMMA COLORE COLOR RANGE



01

BIANCO
WHITE



25

BIANCO MATT
WHITE MATT